



AGENTS NOTE: The property is leasehold with an assignable lease of 99 years with 64 years remaining. Occupants must be 60 years of age or over and have obtained the Estate Manager’s approval for residency. The Service Charge is approximately £2735.76 per year and includes the pull-cord emergency-alert system, Estate Manager services, management fee, window cleaning, maintenance and insurance of the buildings and gardens. Upon re-sale of the property the vendor is liable to pay back into the sinking fund a contribution calculated at 1.5% per annum of the original purchase price for the years owned. This information is correct as of the 27th June 2023.

We understand there may be a Deed of Variation required and recommend you seek advice from your solicitor. We understand there is a Deed of Variation in place and recommend you seek advice from your solicitor.

LOCATION: Wellington is a popular market town boasting an assortment of both independently run shops and larger national stores to include the well renowned Waitrose whilst also benefitting from a range of educational and leisure facilities a Sport Centre, cinema and The Cleve Hotel & Spa. The landmark Wellington Monument showcases extensive views across the Blackdown Hills which is an Area of Outstanding Natural Beauty. There is also a regular bus service to outlying villages and to the County Town of Taunton which is approximately 7 miles distant with its main line railway station. The M5 Motorway can be accessed via Junction 26 just outside Wellington.

GENERAL REMARKS AND STIPULATION

Tenure: The property is offered for sale Leasehold, by private treaty with vacant possession on completion.
Services: Mains electricity, mains water, mains drainage, electric heating, telephone
Local Authority: Somerset Council, County Hall, The Crescent, Taunton, TA1 4DY.
Property Location: w3w.co//still.binders.artichoke
Council Tax Band: A

IMPORTANT NOTICE Wilkie May & Tuckwood for themselves and for the vendors of the property, whose agents they are, give notice that: 1. the particulars are intended to give a fair and substantially correct overall description for the guidance of intending purchaser and do not constitute part of an offer or contract. Prospective purchasers and lessees ought to seek their own professional advice. 2. All descriptions, dimensions, areas, reference to condition and necessary permissions for use and occupation and other details are given in good faith, and are believed to be correct, but any intending purchasers should not rely on them as statements or representations of fact but must satisfy themselves by inspection or otherwise as to the correctness of each of them. 3. No person in the employment of Wilkie May & Tuckwood has any authority to make or give any representations or warranty whatever in relation to this property on behalf of Wilkie May & Tuckwood, nor enter into any contract on behalf of the vendor. 4. No responsibility can be accepted for any expenses incurred by intending purchasers in inspecting properties which have been sold, let or withdrawn. MEASUREMENTS AND OTHER INFORMATION All measurements are approximate. While we endeavour to make our sales particular accurate and reliable, if there is any point which is of particular importance to you, please contact the office and we will be pleased to check the information with you.

Code of Practice for Residential Estate Agents: Effective from 1 August 2011:

‘8. Financial Evaluation 8a At the time that an offer has been made and is being considered by the seller, you must take reasonable steps to find out from the prospective buyer the source and availability of his funds for buying the property and pass this information to the seller. Such information will include whether the prospective buyer needs to sell a property, requires a mortgage, claims to be a cash buyer or any combination of these. Such relevant information that is available should be included in the Memorandum of Sale having regard to the provisions of the Data Protection Act.8b These reasonable steps must continue after acceptance of the offer until exchange of contracts (in Scotland, conclusion of missives) and must include regular monitoring of the prospective buyer’s progress in achieving the funds required and reporting such progress to the seller.

The agent has not tested any apparatus, equipment, fixtures and fittings or services and so cannot verify that they are in working order or fit for their purpose. A Buyer is advised to obtain verification from their solicitor or surveyor. References to the Tenure of the Property are based on information supplied by the Seller. The agent has not had sight of the title documents. A Buyer is advised to obtain verification from their Solicitor.

GROUND FLOOR
53.9 sq.m. (581 sq.ft.) approx.

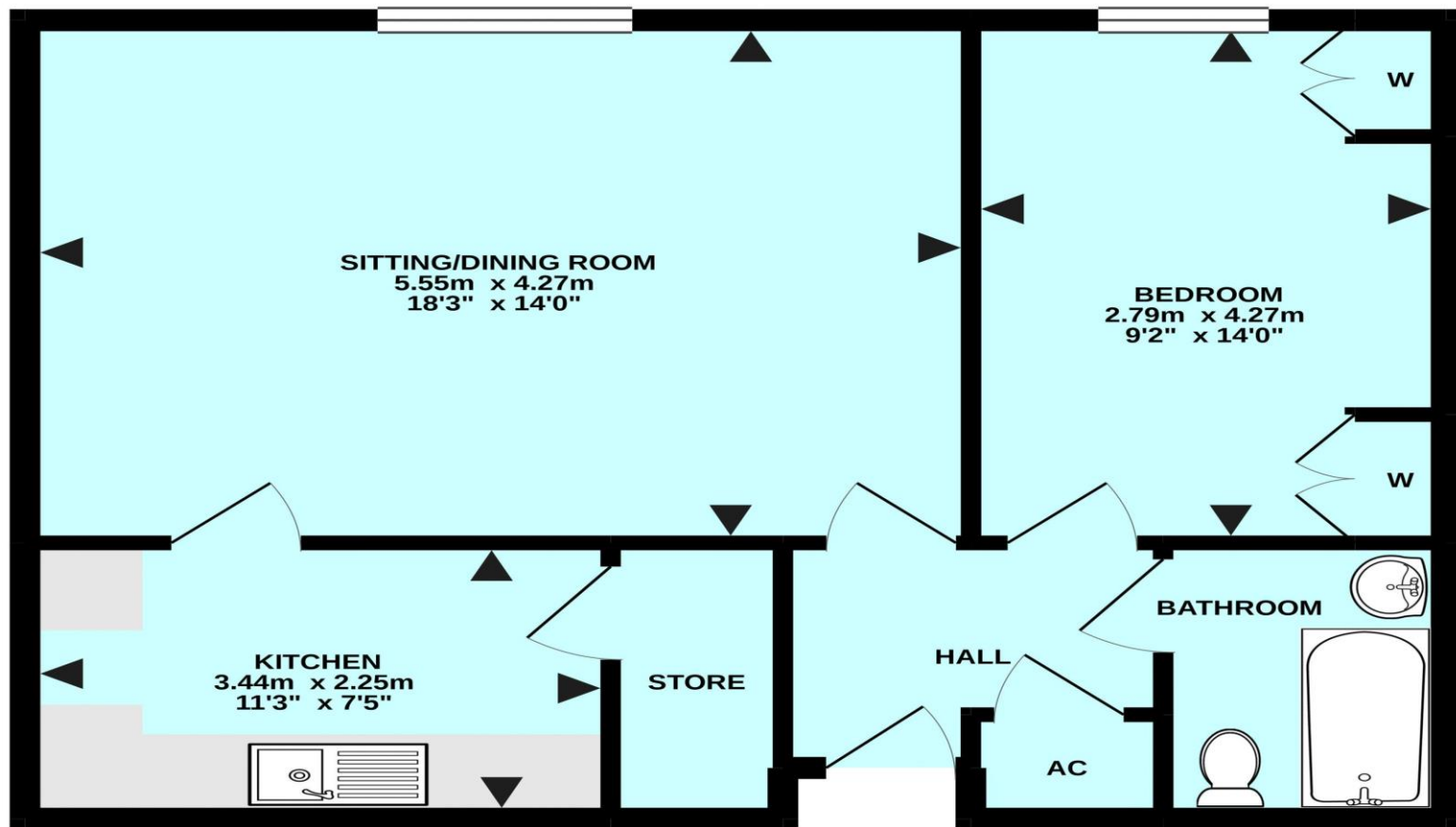

TOTAL FLOOR AREA : 53.9 sq.m. (581 sq.ft.) approx.
Made with Metropix ©2021

19 Priory Court is a one bedroom first floor apartment in a popular retirement complex only a short walk from the town centre.

The apartment itself comprises its own front door leading into the entrance hallway where there is plenty of space for coats and shoes along with an airing cupboard and further storage.

The sitting/dining room offers an electric fireplace and leads to the kitchen/breakfast room with plenty of wall and base units with contrasting worktops and tiled splashbacks. There is a large pantry cupboard allowing additional space.

The bedroom includes fitted wardrobes and is serviced by the family bathroom with a shower over the bath. Residents have use of a delightful and well-tended communal garden, residents lounge with kitchen, laundry room, guest suite for visitors (by arrangement) and a residential House Manager.

Outside, there is an attractive approach to the development with some resident and visitor parking and beautifully tended gardens, well stocked with a variety of mature flower and shrub borders. There are a number of seating areas and a lit pathway through towards the town centre and all of the local amenities on offer.



- Retirement apartment for over 60s
- Overlooking the front elevation
- Well tended communal gardens
- Walking distance to the town centre
- Resident's lounge and guest suite

